

Collection

## POWA

Article

### EL008

Description

**Round wall mounted electronic mixer complete with stabilized power supply for mains.**

Box Dimensions

240x215x110 mm

Weight

2.5 kg

Finishes

- **CC**  
CHROME
- **PL**  
PLATINUM
- **SS**  
BRUSHED  
NICKEL
- **ON**  
NATURAL  
BRASS
- **BO**  
MATT  
WHITE
- **NP**  
MATT  
BLACK
- **CF**  
BLACK  
CHROME
- **CS**  
BRUSHED  
BLACK  
CHROME
- **II**  
PALE  
GOLD
- **IS**  
BRUSHED  
PALE GOLD
- **RS**  
ROSE  
GOLD
- **SR**  
BRUSHED  
ROSE GOLD
- **OO**  
GOLD
- **OS**  
BRUSHED  
GOLD
- **RR**  
ANTIQUÉ  
COPPER
- **MB**  
MODERN  
BRONZE



Dimensions

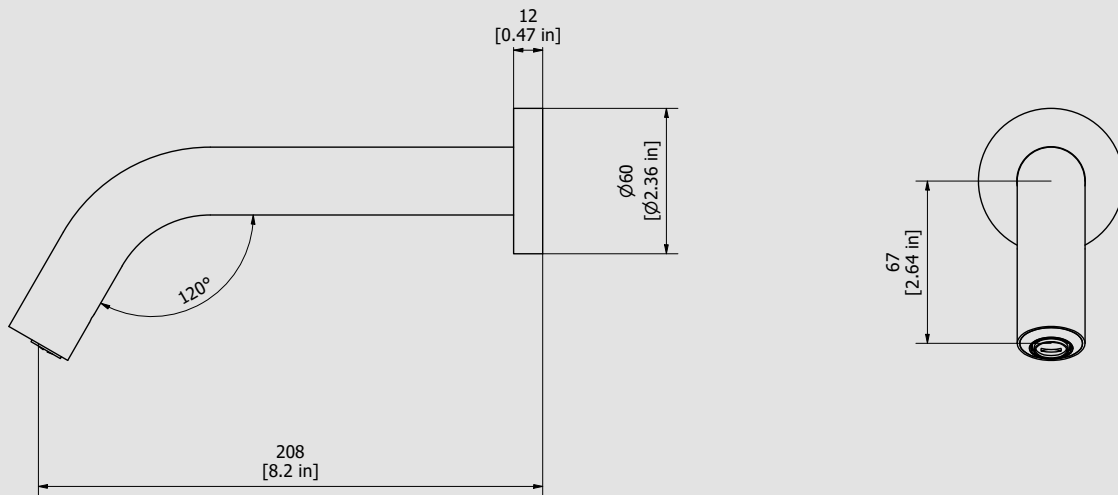

Cartridge

-

Threaded fitting

**Tube flex**

Aerator

**M16.5x1**

Flow Rate (+/-10%)

**1 BAR**  
4.5 l/m

**2 BAR**  
6 l/m

**3 BAR**  
6 l/m

Production

**Main body is a machined from a solid pieces**

Material

**BRASS**  
According to CuZn42 (CW510L)  
Max Lead content: 0.2%



WE ARE IB

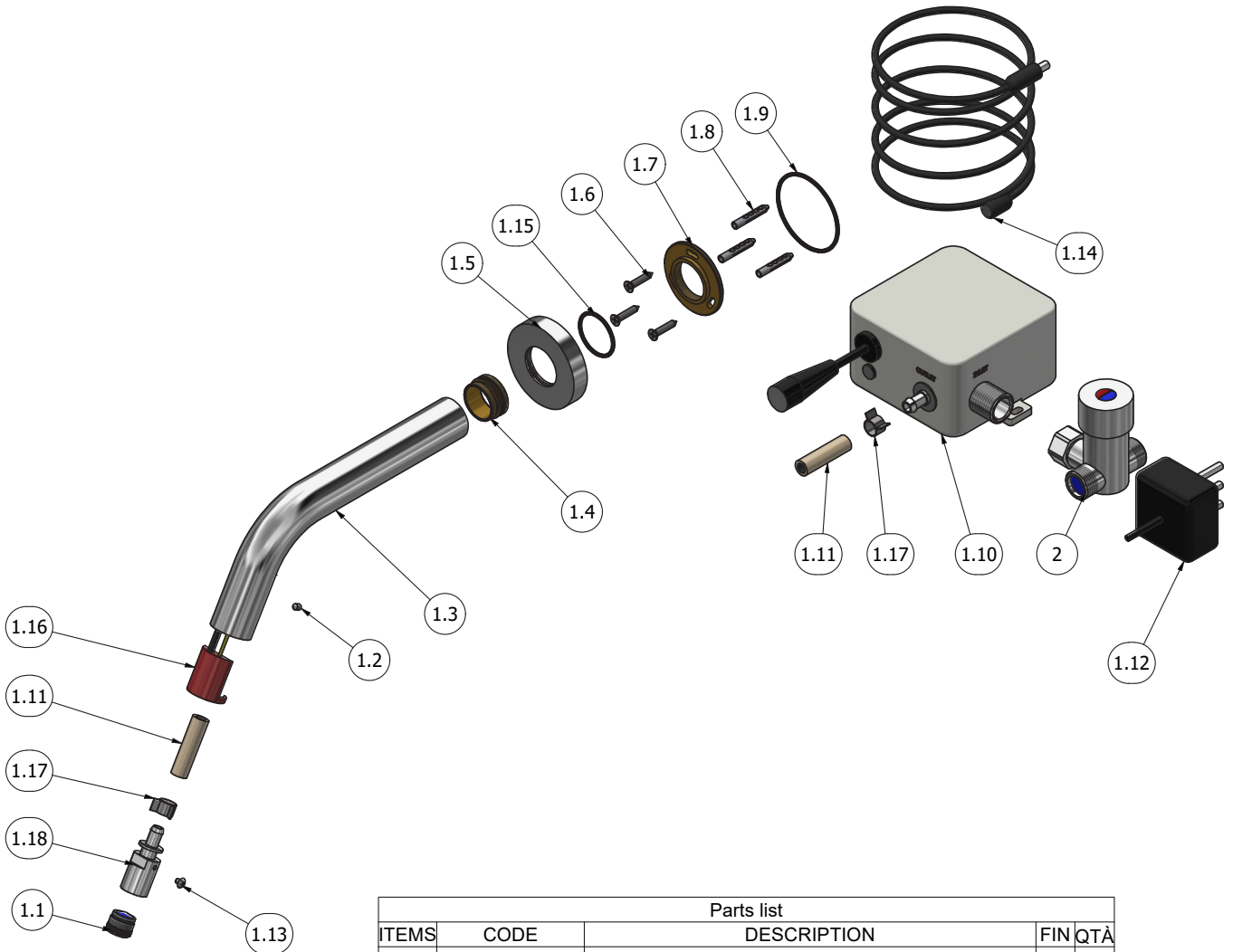

Parts list				
ITEMS	CODE	DESCRIPTION	FIN	QTÀ
1	AQ0018053	Wall-mounted sensor-controlled basin mixer	F	1
1.1	AQ0018053_1	Cachè perlator M16,5 x 1 coin slot (44.3230.450)	-	1
1.2	AQ0018053_2	Grubscrew M4x6 cone point	-	1
1.3	AQ0018053_3	Wall spout Ø28	F	1
1.4	AQ0018053_4	Record M28x1 M26x1 H14	G	1
1.5	AQ0018053_5	Rosette Ø60 H12 M51x1.5	F	1
1.6	AQ0018053_6	Self-tapping screw	G	3
1.7	AQ0018053_7	Fixing nut M51x1.5 M28x1	G	1
1.8	AQ0018053_8	Dowel fisher Ø5	-	3
1.9	AQ0018053_9	OR 52x2 NBR 70 SH	-	1
1.10	AQ0018053_10	Inlet/outlet sensor box	-	1
1.11	AQ0018053_11	Flex Ø11 Ø7	-	1
1.12	AQ0018053_12	Sink power cable	-	1
1.13	AQ0018053_13	Button head screw M3x4	-	1
1.14	AQ0018053_14	Sensor power cable	-	1
1.15	AQ0018053_15	OR 28x2 NBR 70 SH	-	1
1.16	AQ0018053_16	Sensor IRed&Traf (W UK Plug)	-	1
1.17	AQ0018053_17	Clamp Ø10 H8	-	2
1.18	AQ0018053_18	M16.5x1 aerator holder insert	-	1
2	AQ0018152	Temperature adjustment tap	-	1



WE ARE IB

### **WARRANTY**

All IB Rubinetterie SpA products are warranted for 10 years from the date of purchase, for the following cases:

- Defects of casting, porosity and chrome plating.
- Operating defects caused by incorrect fabrication.

The warranty provides for repair or replacement of products with fabrication defects recognized by our technical office. There is no other type of compensation anche the merchandise must be returned FOB our warehouse. The warranty only cover surface defects (scartches, dings, etc.) on fitting that have not been installed and used, returned in its original packaging with all components. O-ring, gasket seals and components subject to wear proportional to use are warranted for 2 years.

#### **The warranty is void in the following cases:**

Error installing and putting the product into service.

Deterioration of finished surfaces due to use of cleaning products containing acids or abrasive substances.

Deterioration of surface with finishes other than chrome plating. Their durability is, in fact, dependent on the user's care and gentleness of use.

Deterioration of the fitting due incorrect installation.

Improper repairs and maintenance performed without the company's prior authorization.

The warranty from IB Rubinetterie SpA is not renewable.

#### **Cleaning**

We recommended cleaning the finish surfaces with water and soap, using a soft cloth.

Do not use detergents that cointain hydrochloric acid or abrasive substances.