

Collection

## HERMES ELLE

Article

### HL700\_2

Description

**Free-standing bath filler mixer**

Box Dimensions

**750x600x350 mm**

Weight

**13 kg**

Finishes

- **CC**  
CHROME
- **PL**  
PLATINUM
- **SS**  
BRUSHED  
NICKEL
- **ON**  
NATURAL  
BRASS
- **BO**  
MATT  
WHITE
- **NP**  
MATT  
BLACK
- **CF**  
BLACK  
CHROME
- **CS**  
BRUSHED  
BLACK  
CHROME
- **II**  
PALE  
GOLD
- **IS**  
BRUSHED  
PALE GOLD
- **RS**  
ROSE  
GOLD
- **SR**  
BRUSHED  
ROSE GOLD
- **OO**  
GOLD
- **OS**  
BRUSHED  
GOLD
- **RR**  
ANTIQUÉ  
COPPER
- **BB**  
ANTIQUÉ  
BRONZE

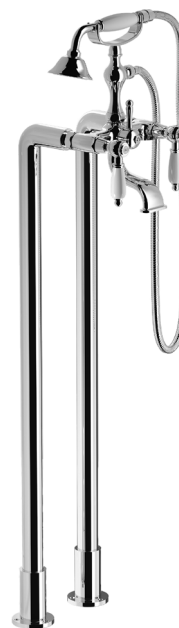

Dimensions

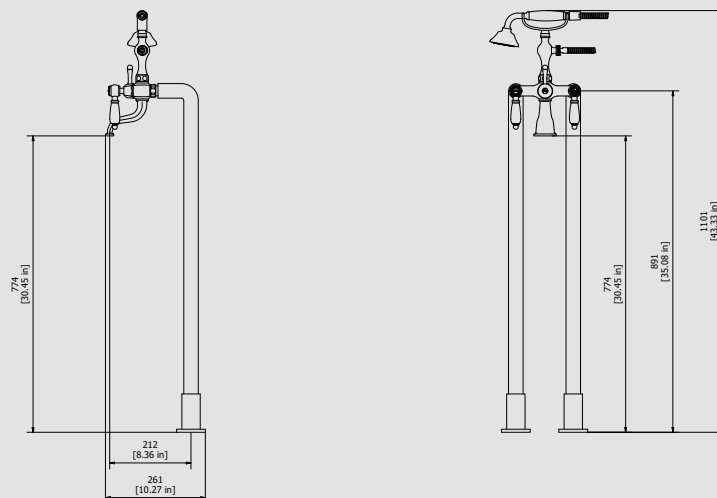

Cartridge

**IB G1/2" ceramics headworks**

Threaded fitting

**Inox hoses G1/2" male**

Aerator

**No aerator, free outlet**

Flow Rate (+/-10%)

1 BAR	2 BAR	3 BAR
23 l\m	31 l\m	37 l\m

Production

**Main body is a single casted piece**

Material

**BRASS**  
According to CuZn35Pb2Al-B (CB752S)  
Max Lead content:1.36%



WE ARE IB

Parts list			
ITEMS	CODE	DESCRIPTION	FIN QTA
1	AQ0013551	Handle's plug hot	- 1
2	AQ0009069	Cover Ø20 PLS	F 2
3	AQ0010985	Inox screw M4x12	- 2
4	AQ0010229	Inox washer Ø4	- 2
5	AC0003397	Lever Ø31.5 H42	F 2
6	AC0004500	Insert for handle	F 2
7	AT0004520	Rod M8x1 L66	G 2
8	AQ0004525	Grip handle	- 2
9	AC0004510	Domed nut	F 2
10	AC0003100	Cap for headwork	F 2
11	AQ0013552	Handle's plug cold	- 1
12	AC0003160	Plug	F 1
13	AC0006778	Lever for diverter	F 1
14	AQ0006931	Grubscrew M8x16 flat point	- 1
15	AC0006777	Lever for deviator	F 1
16	CPKHR250CCX01	Preassembled bath filler	F 1
16.1	CC0001540	Body bath mixer	F 1
16.2	AQ0002135	Ceramic headwork 90° left	- 1
16.3	AQ0003930	Ceramic headwork 90° right	- 1
16.4	AS0008071	Diverter's nut W22x19	G 1
16.5	AQ0009385	OR 18x2.2 NBR 70 SH	- 2
16.6	AQ0006645	OR 7.66x1.78 NBR 70 SH	- 2
16.7	AS0008070	Diverter commander Ø19 H42.2	G 1
16.8	AQ0001400	OR 20.35x1.78 NBR 70 SH	- 1
16.9	AC0003125	Bathfiller's spout	F 1
16.10	AC0000710	Fixing nut G3/4" H14 CH30	F 2
16.11	AQ0004600	OR 15.6x1.78 NBR 70 SH	- 2
16.12	AN0008067	Threaded connecting piece M18x1.5 H28.6	N 2
16.13	AQ0009254	OR 9x3 NBR 70 SH	- 2
16.14	AS0008069	Diverter's valve Ø19 H44	G 1
16.15	AN0008068	Junction W21x19 G3/4" L18.8	N 1
16.16	AQ0010009	Rubber packing G3/4" 24x16x3	- 1
16.17	AN0006835	Junction Ø23 G3/8" L16	N 1
16.18	AQ0001350	OR 11.11x1.78 NBR 70 SH	- 2
16.19	AC0006830	Nut for extension	F 1
16.20	AC0009348	Extension Ø28.5 G3/8" H103.5	F 1
16.21	AC0009334	Hose connection G3/8" G1/2" L29	F 1
16.22	AC0009349	Thickness ring	F 1
16.23	AC0003130	Handshower's support	F 1
17	AQ0003120	Fless. d. agg. G1/2" G G1/2" cone L150	- 1
18	AQ0008031	White Old America shower	F 1
19	AQ0001600	Gasket 24x16x2 G3/4"	- 2
20	AQ0009898	Extension pipe H890	F 1

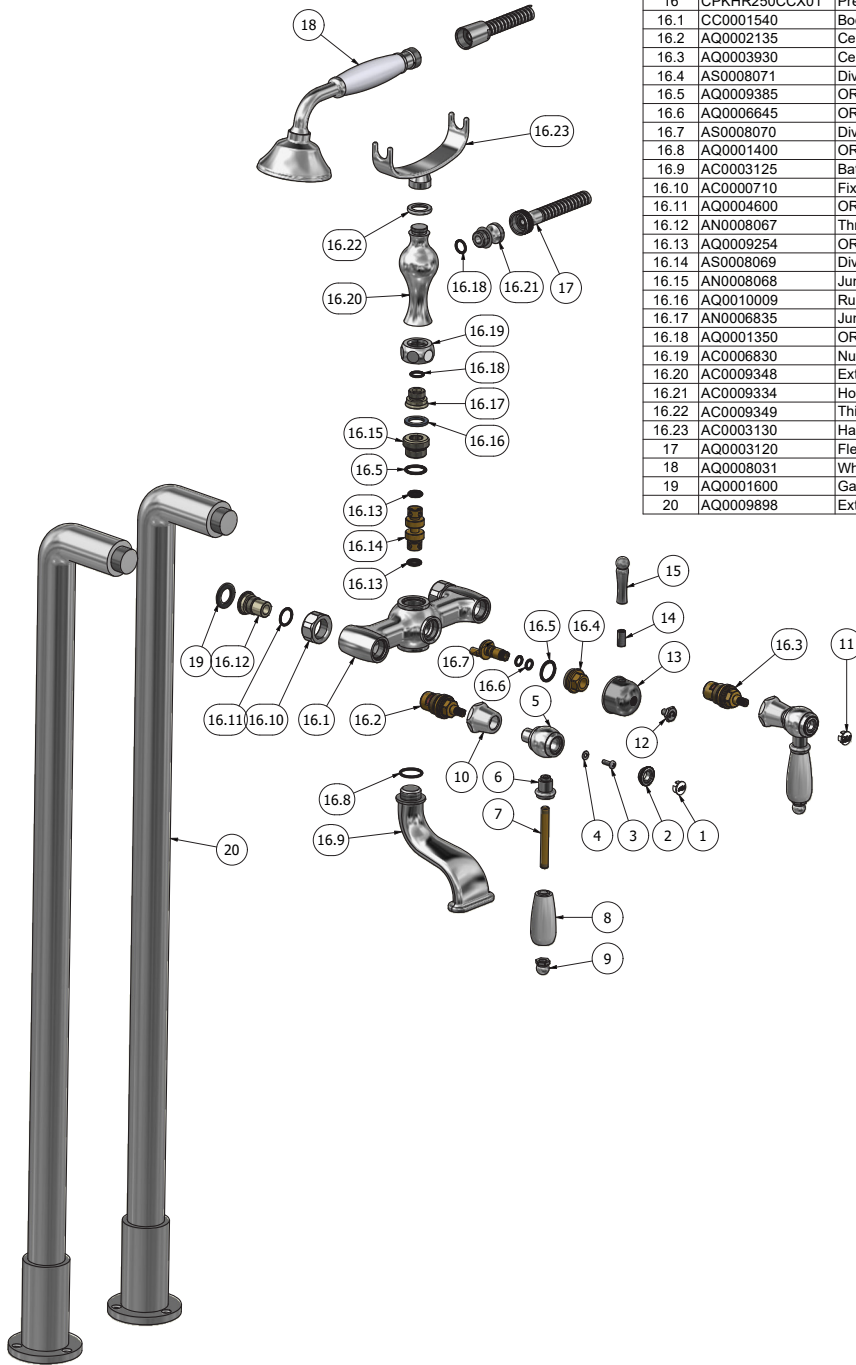



WE ARE IB

### **WARRANTY**

All IB Rubinetterie SpA products are warranted for 10 years from the date of purchase, for the following cases:

- Defects of casting, porosity and chrome plating.
- Operating defects caused by incorrect fabrication.

The warranty provides for repair or replacement of products with fabrication defects recognized by our technical office. There is no other type of compensation anche the merchandise must be returned FOB our warehouse. The warranty only cover surface defects (scartches, dings, etc.) on fitting that have not been installed and used, returned in its original packaging with all components. O-ring, gasket seals and components subject to wear proportional to use are warranted for 2 years.

#### **The warranty is void in the following cases:**

Error installing and putting the product into service.

Deterioration of finished surfaces due to use of cleaning products containing acids or abrasive substances.

Deterioration of surface with finishes other than chrome plating. Their durability is, in fact, dependent on the user's care and gentleness of use.

Deterioration of the fitting due incorrect installation.

Improper repairs and maintenance performed without the company's prior authorization.

The warranty from IB Rubinetterie SpA is not renewable.

#### **Cleaning**

We recommended cleaning the finish surfaces with water and soap, using a soft cloth.

Do not use detergents that cointain hydrochloric acid or abrasive substances.